

- NOTES**
1. ALL DIMENSIONS SHALL BE CHECKED AND CO-RELATED WITH THE STRUCTURAL DRAWINGS AND ANY AMBIGUITY SHALL BE IMMEDIATELY BROUGHT TO THE NOTICE OF THE ARCHITECT BEFORE COMMENCEMENT OF THE WORK.
  2. ALL DIMENSIONS ARE IN CENTIMETERS UNLESS AND OTHERWISE SPECIFIED.
  3. ALL LEVELS ARE FINISHED LEVELS.
  4. ALL MARGINS, CLEARANCES ETC. REQUIRED AS PER BYE-LAWS SHOULD BE CHECKED AND PROVIDED BY THE CONTRACTOR AND ANY DISCREPANCIES FOUND SHOULD BE IMMEDIATELY BROUGHT TO THE NOTICE OF ARCHITECT BEFORE COMMENCEMENT OF WORK.

DOOR SCHEDULE						
NO.	WIDTH	HEIGHT	FALL	TYPE	APARTMENT TYPE	
D1	120	210	-	205	SHOULDER SHUTTER DOOR	1,2,3
D2	90	210	-	205	SHOULDER SHUTTER DOOR	1,2,3
D3	75	210	-	210	SHOULDER SHUTTER DOOR	1,2,3
D4	90	210	-	210	SHOULDER SHUTTER DOOR	1,2,3
D5	150	200	-	200	WALL DOOR	1,2,3
D6	300	211.5	-	211.5	SINGLE SHUTTER DOOR	1
D7	300	210	-	200	DOUBLE SHUTTER DOOR	1,2,3
D8	180	210	-	205	SHOULDER SHUTTER DOOR	3
D9	400	190	-	200	DOUBLE SHUTTER DOOR	1

WINDOW SCHEDULE					
NO.	WIDTH	HEIGHT	FALL	TYPE	APARTMENT TYPE
W1	180	142.5	225	DOUBLE SHUTTER WOODEN WINDOW	1,2,3
W2	270	142.5	225	DOUBLE SHUTTER WOODEN WINDOW	1,2
W3	120	95.5	235	SHOULDER SHUTTER WOODEN WINDOW	1,2
W4	150	142.5	225	DOUBLE SHUTTER WOODEN WINDOW	1,2
W5	90	94.5	235	SHOULDER SHUTTER WOODEN WINDOW	1,2,3
W6	300	175	17	DOUBLE SHUTTER WOODEN WINDOW	1
W7	150	200	17	DOUBLE SHUTTER WOODEN WINDOW	1
W8	120	108	17	DOUBLE SHUTTER WOODEN WINDOW	2
W9	120	108	182	SHOULDER WINDOW	1,2,3

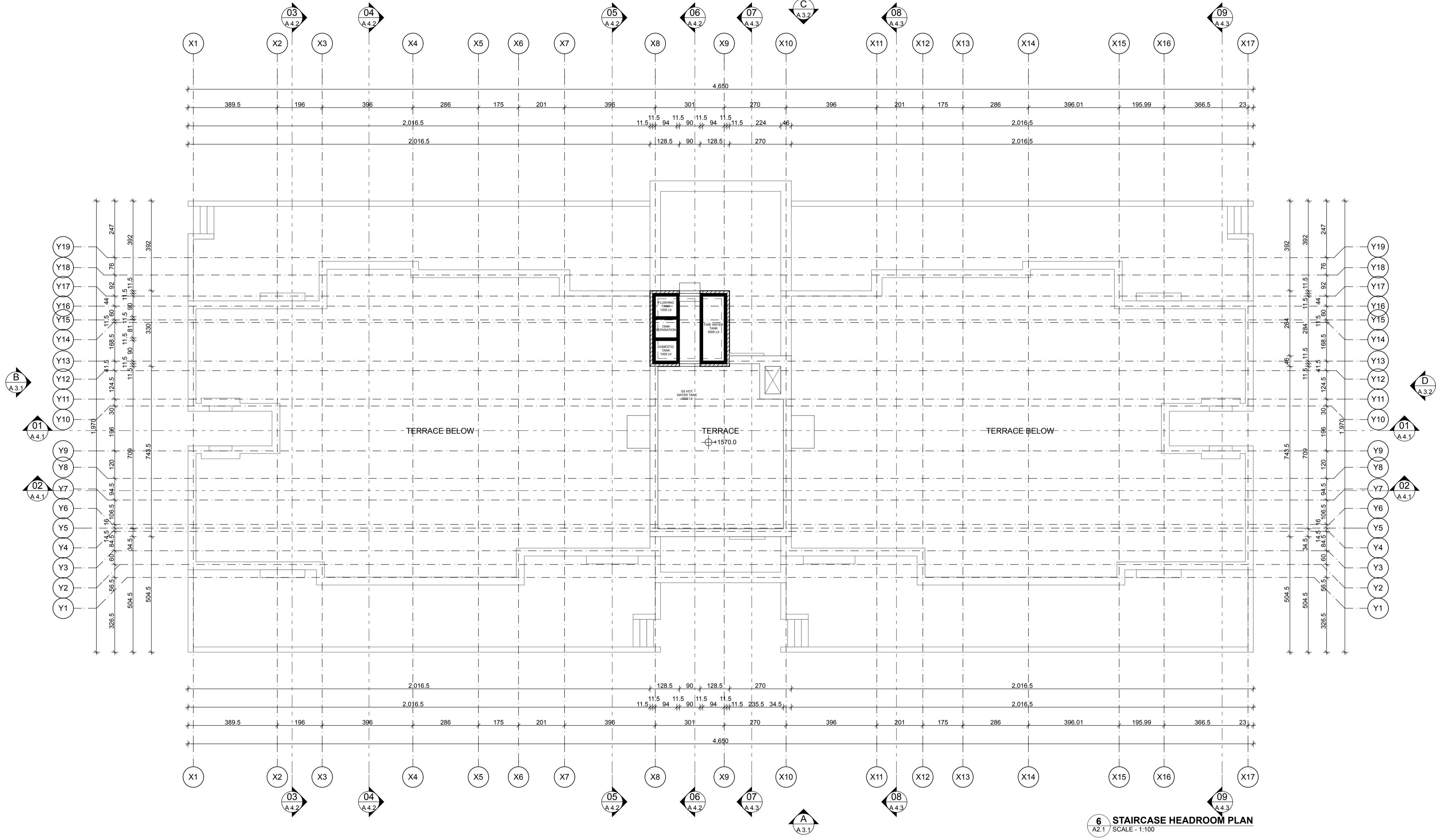

TENDER DRAWINGS

Key Plan

- Consultants**
- Structural Consultants**  
VR SHAH Consulting Engineers
  - Services Consultants**  
DBHMS
  - Landscape Consultants**  
Earthscape Consultancy Pvt Ltd
  - Road and Pathways Consultants**  
Anhmm Infra Consultants LLP

Project

**Nalanda University, Rajgir, Bihar**

Title  
**Faculty Apartment**  
**Type 1B- Staircase headroom Plan**

Dealt : Janardhan  
Checked : Piyas Choudhuri  
Scale : As Shown  
Date : 13/02/17

**VASTU SHILPA CONSULTANTS**  
Architects | Planners | Urban Designers

'Sangath', Thaltej Road, Ahmedabad - 380054  
Phone: 079 - 27454537 Fax: 079 - 27452006  
www.sangath.org e-mail: vsc@sangath.org