

- NOTES**
1. ALL DIMENSIONS SHALL BE CHECKED AND CO-RELATED WITH THE STRUCTURAL DRAWINGS AND ANY AMBIGUITY SHALL BE IMMEDIATELY BROUGHT TO THE NOTICE OF THE ARCHITECT BEFORE COMMENCEMENT OF THE WORK.
 2. ALL DIMENSIONS ARE IN CENTIMETERS UNLESS AND OTHERWISE SPECIFIED.
 3. ALL LEVELS ARE FINISHED LEVELS.
 4. ALL MARGINS, CLEARANCES ETC. REQUIRED AS PER BYE-LAWS SHOULD BE CHECKED AND PROVIDED BY THE CONTRACTOR AND ANY DISCREPANCIES FOUND SHOULD BE IMMEDIATELY BROUGHT TO THE NOTICE OF ARCHITECT BEFORE COMMENCEMENT OF WORK.

TENDER DRAWINGS

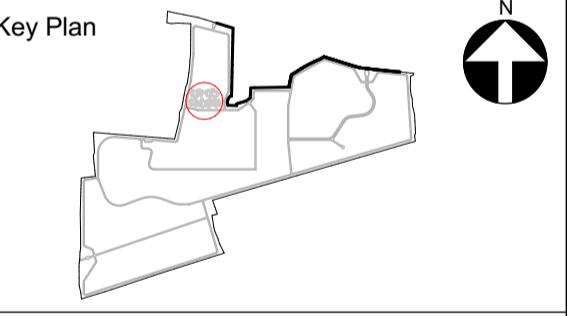

- Consultants**
- Structural Consultants**
VR SHAH Consulting Engineers
 - Services Consultants**
DBHMS
 - Landscape Consultants**
Earthscape Consultancy Pvt Ltd
 - Road and Pathways Consultants**
Arhmm Infra Consultants LLP

Project

Nalanda University, Rajgir, Bihar

Title

Students Housing- Cluster Type 5

Sections

Dealt : Jeimii	Drawing No. NUC(1)-SH- A.T5.4.3
Checked : Piyas Choudhuri	Serial No. ###
Scale :	
Date : 15-Nov-16	