

- NOTES**
1. ALL DIMENSIONS SHALL BE CHECKED AND CO-RELATED WITH THE STRUCTURAL DRAWINGS AND ANY AMBIGUITY SHALL BE IMMEDIATELY BROUGHT TO THE NOTICE OF THE ARCHITECT BEFORE COMMENCEMENT OF THE WORK.
 2. ALL DIMENSIONS ARE IN CENTIMETERS UNLESS OTHERWISE SPECIFIED
 3. ALL LEVELS ARE FINISHED LEVELS.
 4. ALL MARGINS, CLEARANCES ETC. REQUIRED AS PER BYE-LAWS SHOULD BE CHECKED AND PROVIDED BY THE CONTRACTOR AND ANY DISCREPANCIES FOUND SHOULD BE IMMEDIATELY BROUGHT TO THE NOTICE OF ARCHITECT BEFORE COMMENCEMENT OF WORK.

ELECTRICAL LEGEND:	
	6A 3PIN SWITCHED SOCKET OUTLET.
	6/16A 6PIN SWITCH SOCKET OUTLET.
	16A 6PIN SWITCHED SOCKET OUTLET.
	DISTRIBUTION BOARD : 1600mm ABOVE SFL.

No.	Date.	Remarks.
Revisions		

Date	Prints	Issued to	Date	Prints	Issued to
Distribution of Prints					

Key Plan

- Consultants**
- Structural Consultants**
VR SHAH Consulting Engineers
 - Services Consultants**
 dbHMS
2nd Floor, D-62, Sector -2, Noida - 201301
www.dbhms.in
 - Landscape Consultants**
Earthscapes Consultancy Pvt Ltd
 - Road and Pathways Consultants**
Arhmm Infra Consultants LLP

Project
Nalanda University, Faculty Apartment, Rajgir, Bihar

Title
GROUND FLOOR PLAN - POWER LAYOUT
FOR TENDER

Dealt : V.K	Drawing No. NUC(1)-FAH-T2-E2.1.1
Checked : M.T	Approved By : V.M.
Scale : 1:75	Date : 03.06.2016

VASTU SHILPA CONSULTANTS
Architects | Planners | Urban Designers

'Sangath', Thaltej Road, Ahmedabad - 380054
Phone: 079 - 27454537 Fax: 079 - 27452006
www.sangath.org e-mail: vsc@sangath.org

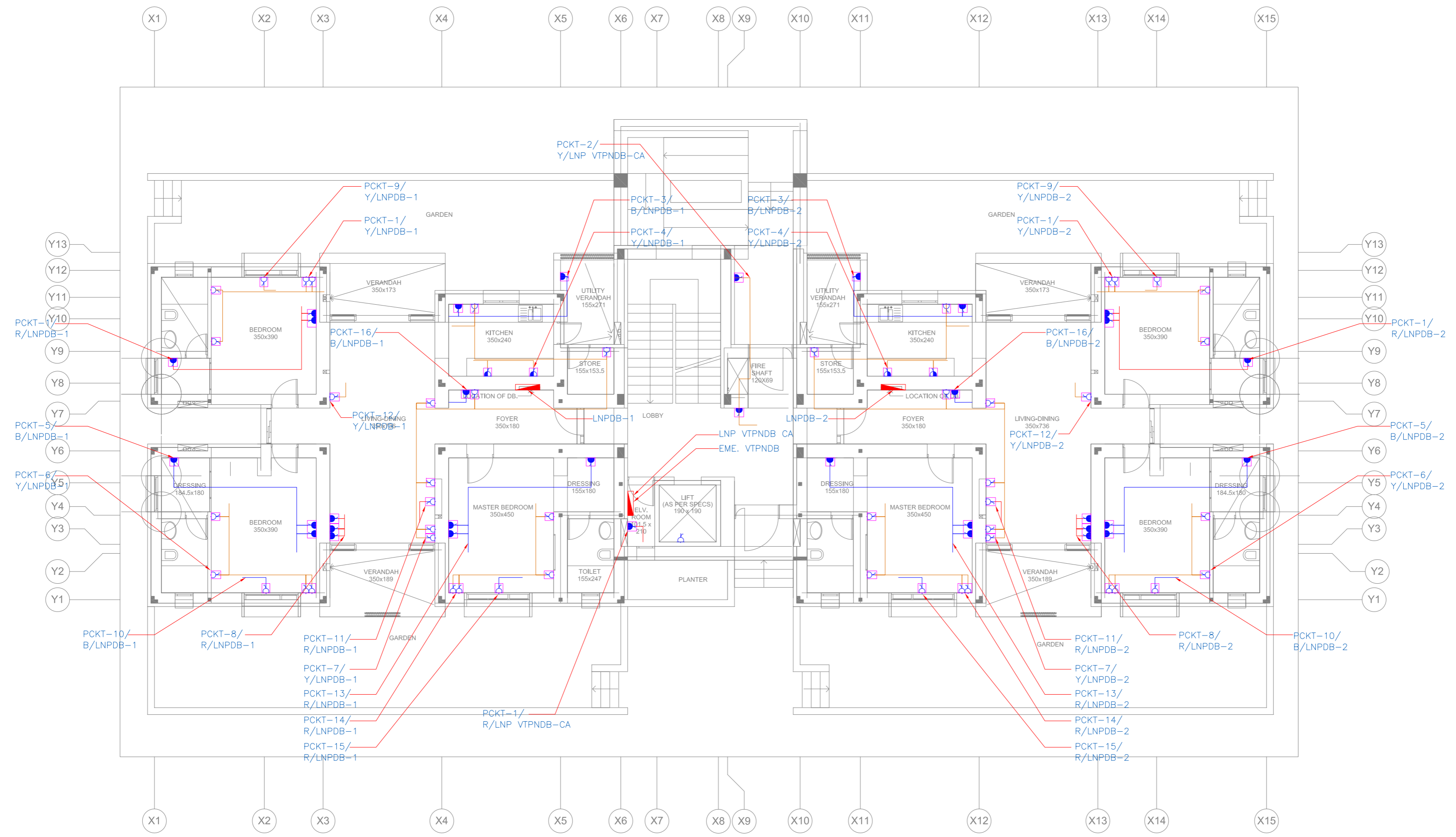

1 Ground Floor Plan - Power Layout