

- NOTES**
- ALL DIMENSIONS SHALL BE CHECKED AND CO-RELATED WITH THE STRUCTURAL DRAWINGS AND ANY AMBIGUITY SHALL BE IMMEDIATELY BROUGHT TO THE NOTICE OF THE ARCHITECT BEFORE COMMENCEMENT OF THE WORK.
 - ALL DIMENSIONS ARE IN CENTIMETERS UNLESS OTHERWISE SPECIFIED.
 - ALL LEVELS ARE FINISHED LEVELS.
 - ALL MARGINS, CLEARANCES ETC. REQUIRED AS PER BYE-LAWS SHOULD BE CHECKED AND PROVIDED BY THE CONTRACTOR AND ANY DESCRIPIECIES FOUND SHOULD BE IMMEDIATELY BROUGHT TO THE NOTICE OF ARCHITECT BEFORE COMMENCEMENT OF WORK.

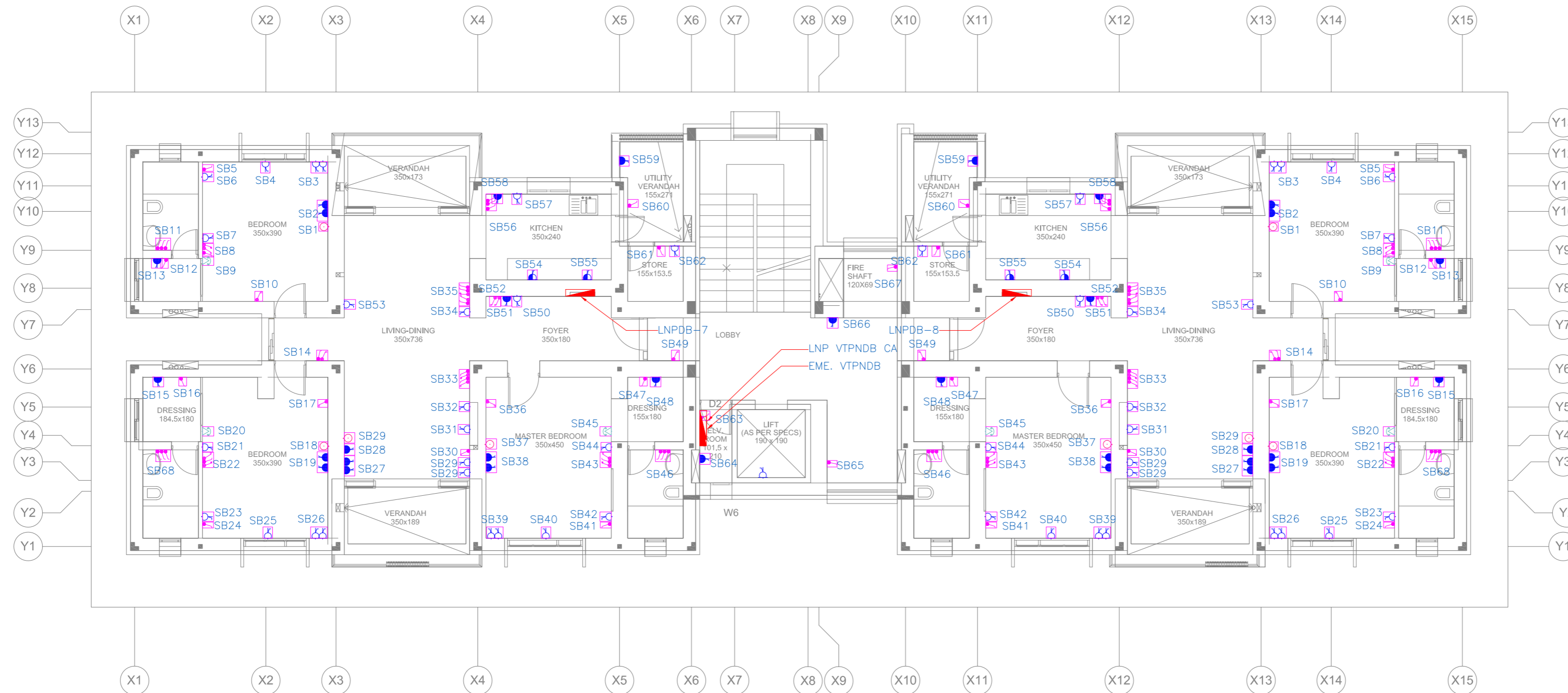

6 Third Floor Plan - SB Detail



No.	Date.	Remarks.
Revisions		

Date	Prints	Issued to	Date	Prints	Issued to

Distribution of Prints

Key Plan

- Consultants**
- Structural Consultants**
VR SHAH Consulting Engineers
 - Services Consultants**
 dbHMS
2nd Floor, D-62, Sector -2,
Noida - 201301
www.dbhms.in
 - Landscape Consultants**
Earthscapes Consultancy Pvt Ltd
 - Road and Pathways Consultants**
Arhmm Infra Consultants LLP

Project
Nalanda University, Faculty
Apartment, Rajgir, Bihar

Title
THIRD FLOOR PLAN - SB DETAIL
FOR TENDER

Dealt : V.K	Drawing No.
Checked : M.T	NUC(1)-FAH-T2-E2.4.6
Scale : 1:75	Approved By : V.M.
Date : 03.06.2016	

VASTU SHILPA CONSULTANTS
Architects | Planners | Urban Designers

'Sangath', Thaltej Road, Ahmedabad - 380054
Phone: 079 - 27454537 Fax: 079 - 27452006
www.sangath.org e-mail: vsc@sangath.org