

- NOTES**
- ALL DIMENSIONS SHALL BE CHECKED AND CO-RELATED WITH THE STRUCTURAL DRAWINGS AND ANY AMBIGUITY SHALL BE IMMEDIATELY BROUGHT TO THE NOTICE OF THE ARCHITECT BEFORE COMMENCEMENT OF THE WORK.
 - ALL DIMENSIONS ARE IN CENTIMETERS UNLESS AND OTHERWISE SPECIFIED.
 - ALL LEVELS ARE FINISHED LEVELS.
 - ALL MARGINS, CLEARANCES ETC. REQUIRED AS PER BYELAWS SHOULD BE CHECKED AND PROVIDED BY THE CONTRACTOR AND ANY DISCREPANCIES FOUND SHOULD BE IMMEDIATELY BROUGHT TO THE NOTICE OF ARCHITECT BEFORE COMMENCEMENT OF WORK.

LEGEND		
S.N.	DESCRIPTION	SYM.
1.	SP	SOIL PIPE
2.	WP	WASTE PIPE
3.	CWS	COLD WATER SUPPLY
4.	FWS	FLUSHING W. SUPPLY
5.	HWS	HOT WATER SUPPLY
6.	ROWS	RO WATER SUPPLY
7.	FWR	FLUSHING WATER RISER
8.	CWR	COLD WATER RISER
9.	FD	FLOOR DRAIN
10.	FT	FLOOR TRAP
11.	COP	CLEAN OUT PLUG
12.	FCO	FLOOR CLEAN PLUG
13.	RWP	RAIN WATER PIPE
14.	CB	CATCH BASIN
15.	MH	MANHOLE
16.	GT	GULLY TRAP

No.	Date.	Remarks.			
Revisions					
Date	Prints	Issued to	Date	Prints	Issued to
Distribution of Prints					

Key Plan

- Consultants**
- Structural Consultants**
VR SHAH Consulting Engineers
 - Services Consultants**
 dbHMS
2nd Floor, D-62, Sector -2,
Noida - 201301
www.dbhms.in
 - Landscape Consultants**
Earthscapes Consultancy Pvt Ltd
 - Road and Pathways Consultants**
Arhmm Infra Consultants LLP

Project
Nalanda University, Faculty Apartment, Rajgir, Bihar

Title
GROUND FLOOR PLAN - PLUMBING
FOR TENDER

Dealt :	JK	Drawing No.
Checked :	AT	NUC(1)-FAH-T2-P2.1
Scale :	1:75	Approved By :
Date :	20.05.2016	VM

VASTU SHILPA CONSULTANTS
Architects | Planners | Urban Designers

'Sangath', Thaltej Road, Ahmedabad - 380054
Phone: 079 - 27454537 Fax: 079 - 27452006
www.sangath.org e-mail: vsc@sangath.org

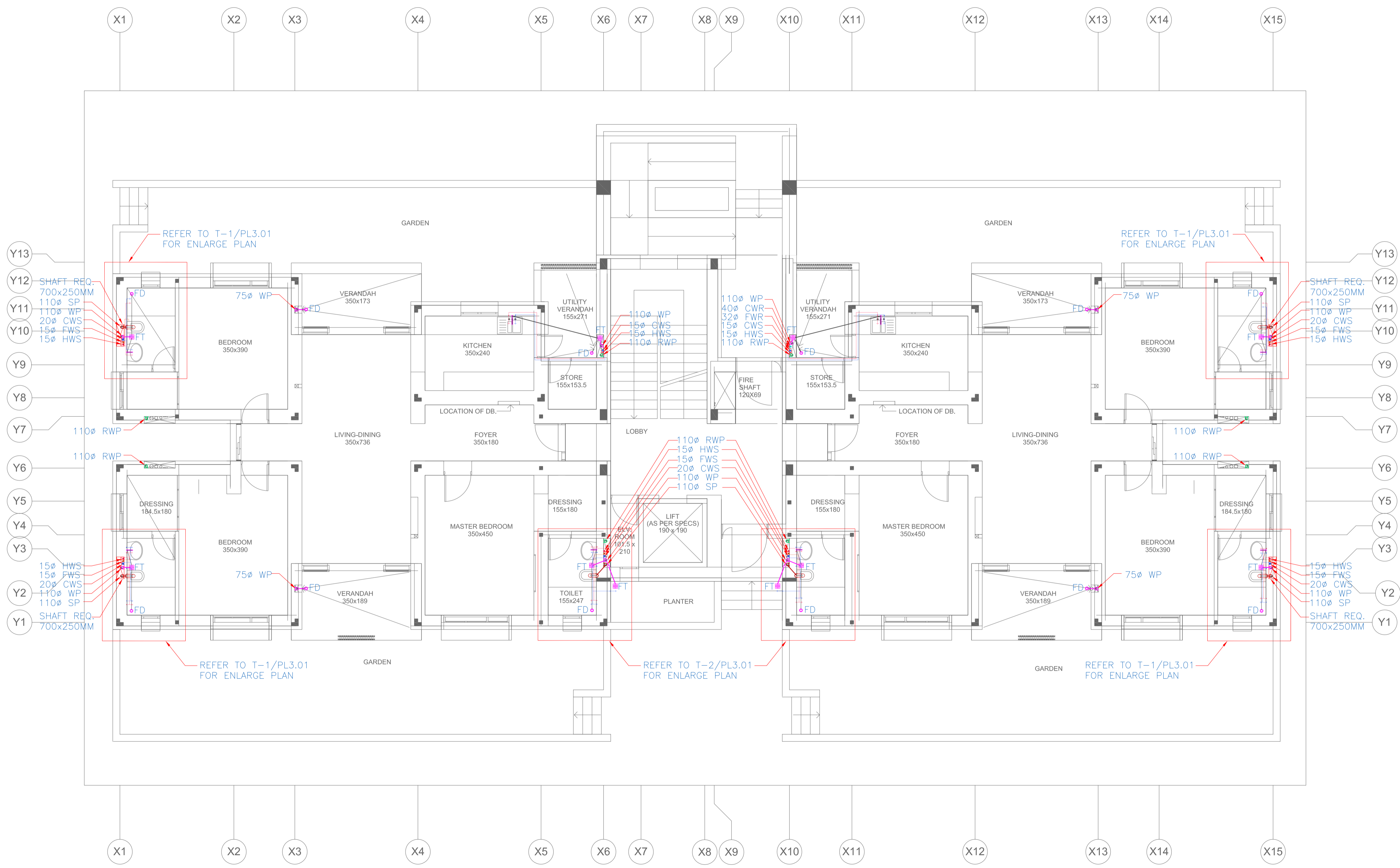

1 Ground Floor Plan - Plumbing