

ELECTRICAL LEGEND:	
	WALL MOUNTED LIGHT FIXTURE : 2600mm AFF AT KITCHEN : 2500mm AFF AT ENTRANCE FOYER : 2200mm AFF AT OTHER PLACES
	14W. LED LIGHT FIXTURE
	10W. LED LIGHT FIXTURE
	9W. FOOT LIGHT
	3W. LED MIRROR LIGHT FIXTURE
	EXHAUST FAN.
	OUTLET FOR CEILING FAN.
	LIFT LIGHT
	TUBELIGHT
	SINGLE POLE SWITCH FOR LIGHTING & FAN AT 1200mm SFL.
	FAN REGULATOR AT 1200mm SFL.
	6A 3PIN SWITCHED SOCKET OUTLET.
	16A 6PIN SWITCHED SOCKET OUTLET.
	6/16A 6PIN SWITCH SOCKET OUTLET.
	TELEPHONE SOCKET OUTLET AT 625mm SFL. (TWIN JACK POINT FOR INTERCOM.)
	CONDUIT PROVISION FOR DATA WITH DUMMY PLATE AT 625mm SFL. IN ALL ROOMS
	TV AERIAL SOCKET OUTLET AT 625mm SFL.
	CALL BELL POINT AT 2600mm SFL.
	BELL PUSH AT 1200mm SFL.
	DISTRIBUTION BOARD : 1600mm ABOVE SFL.

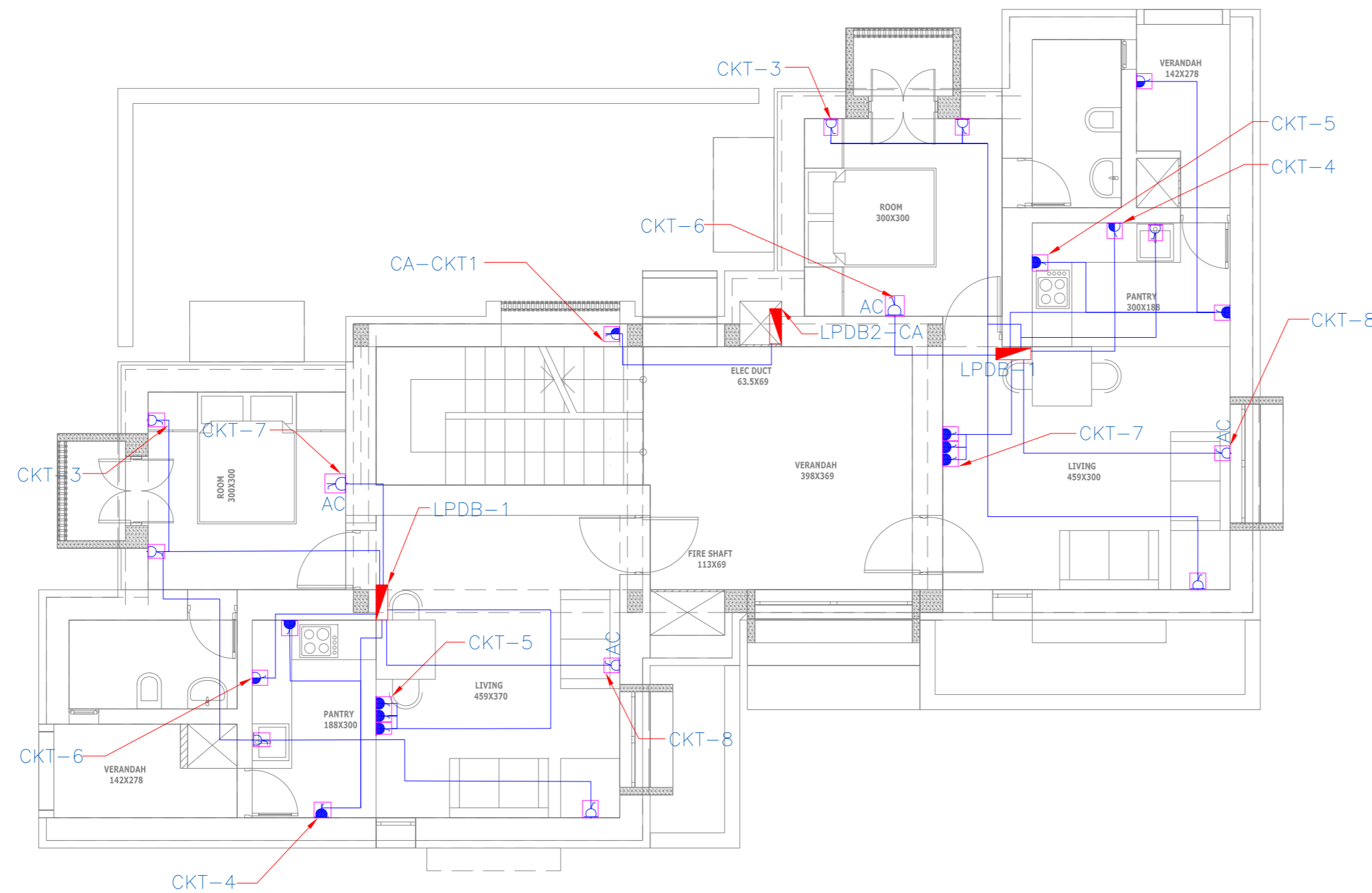

- NOTES
1. ALL DIMENSIONS SHALL BE CHECKED AND CO-RELATED WITH THE STRUCTURAL DRAWINGS AND ANY AMBIGUITY SHALL BE IMMEDIATELY BROUGHT TO THE NOTICE OF THE ARCHITECT BEFORE COMMENCEMENT OF THE WORK.
 2. ALL DIMENSIONS ARE IN CENTIMETERS UNLESS AND OTHERWISE SPECIFIED.
 3. ALL LEVELS ARE FINISHED LEVELS.
 4. ALL MARGINS, CLEARANCES ETC. REQUIRED AS PER BYE-LAWS SHOULD BE CHECKED AND PROVIDED BY THE CONTRACTOR AND ANY DISCREPANCIES FOUND SHOULD BE IMMEDIATELY BROUGHT TO THE NOTICE OF ARCHITECT BEFORE COMMENCEMENT OF WORK.
 5. FOR DETAILS OF ALL CUTOUTS IN SLABS AND BEAMS REFER SERVICES CONSULTANTS DRAWINGS.
 6. FOR STAIRCASE DETAILS REFER DRAWING. NO. 6.1
 7. FOR TOILET DETAILS REFER DRAWING. NO. 6.1
 8. FOR DOOR DETAILS REFER DRWG NO. 9.1
 9. FOR WINDOW DETAILS REFER DRWG NO. 9.1
 10. FOR KITCHEN - PANTRY DETAILS REFER DRWG NO. 10.1
 11. FOR MISCELLANEOUS DETAILS REFER DRAWING NO. 29.1
 12. FOR VERANDAH DETAILS REFER DRAWING NO. 31.1

No.	Date.	Remarks.
Revisions		

Date	Prints	Issued to	Date	Prints	Issued to

Distribution of Prints

Key Plan

- Consultants
- Structural Consultants
VR SHAH Consulting Engineers
 - Services Consultants

dbHMS
2nd Floor, D-62, Sector -2,
Noida - 201301
www.dbhms.in
 - Landscape Consultants
Earthscaapes Consultancy Pvt Ltd
 - Road and Pathways Consultants
Arthmm Infra Consultants LLP

Project

Nalanda University, Rajgir, Bihar

Title

**FIRST FLOOR PLAN - POWER LAYOUT
FOR TENDER**

Dealt :	v.k.	Drawing No.	NUC(1)-MSH-E2.2.1
Checked :	M.T.	Scale :	1:50
Date :	06.06.2016	Aprd By :	V.M.

VASTU SHILPA CONSULTANTS
Architects | Planners | Urban Designers

'Sangath', Thaltej Road, Ahmedabad - 380054
Phone: 079 - 27454537 Fax: 079 - 27452006
www.sangath.org e-mail: vsc@sangath.org

1 FIRST FLOOR PLAN - POWER LAYOUT