

## Elevation

Scale (1:40)

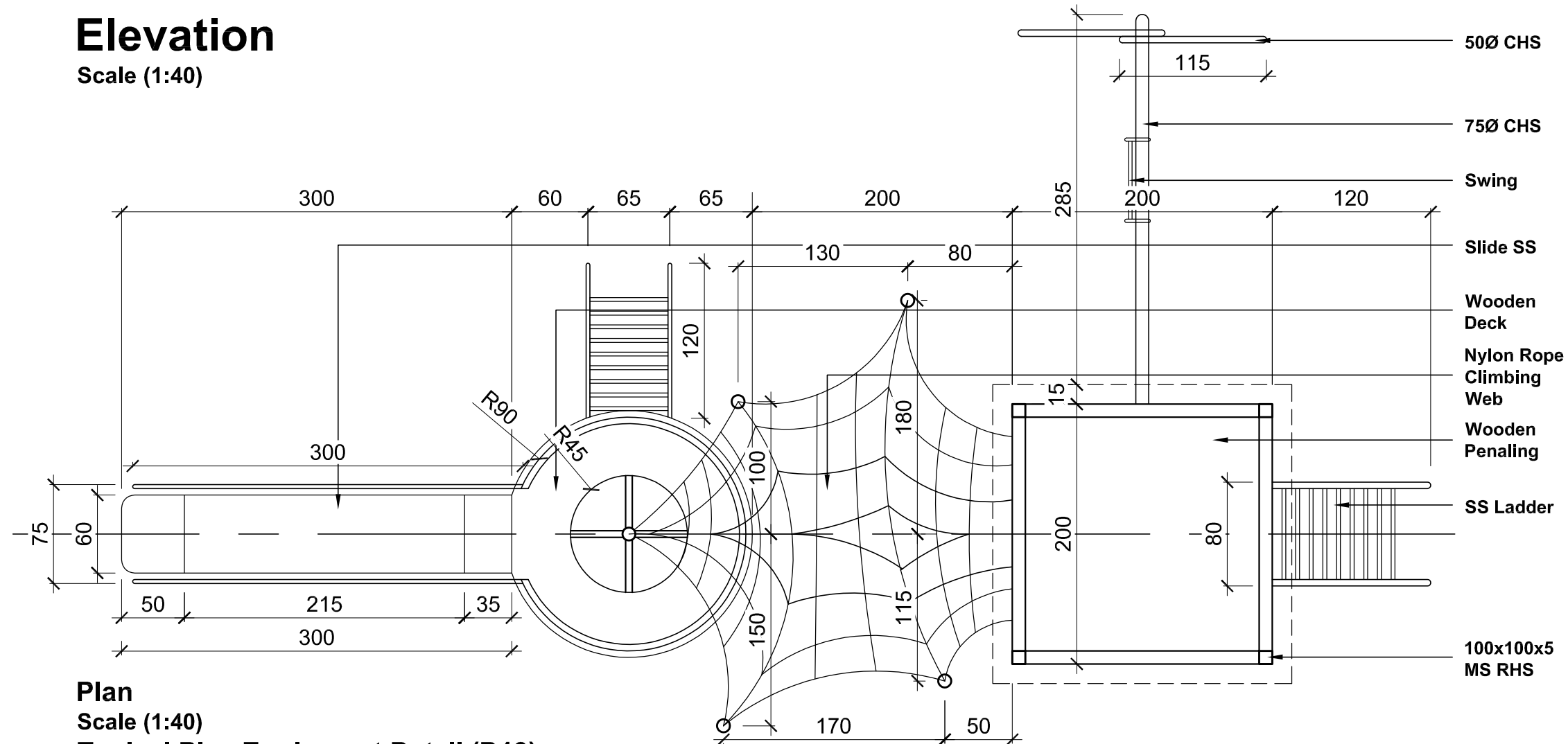

## Plan

Scale (1:40)

Typical Play Equipment Detail (D19)

NOTES  
1. ALL DIMENSIONS SHALL BE CHECKED AND CO-RELATED WITH THE ARCHITECTURAL, STRUCTURAL AND LANDSCAPE DRAWINGS AND ANY AMBIGUITY SHALL BE IMMEDIATELY BROUGHT TO THE NOTICE OF THE ARCHITECT BEFORE COMMENCEMENT OF THE WORK.  
2. ALL DIMENSIONS ARE IN CENTIMETERS UNLESS AND OTHERWISE SPECIFIED.  
3. ALL LEVELS ARE FINISHED LEVELS.  
4. ALL MARGINS, CLEARANCES ETC. REQUIRED AS PER BYE-LAWS SHOULD BE CHECKED AND PROVIDED BY THE CONTRACTOR AND ANY DISCREPANCIES FOUND SHOULD BE IMMEDIATELY BROUGHT TO THE NOTICE OF ARCHITECT BEFORE COMMENCEMENT OF WORK.

No.	Date.	Remarks.
-----	-------	----------

Revisions

No.	Date.	Remarks.
-----	-------	----------

Date	Prints	Issued to	Date	Prints	Issued to
------	--------	-----------	------	--------	-----------

Distribution of Prints

Key Plan

N  
↑

Consultants

○ **Structural Consultants**  
VR SHAH Consulting Engineers

○ **Services Consultants**  
DBHMS

● **Landscape Consultants**  
Earthscape Consultancy Pvt Ltd

○ **Road and Pathways Consultants**  
Arhmm Infra Consultants LLP

Project

**Nalanda University, Rajgir, Bihar**

Title

**Typical Play Equipment Details**

Dealt :	Romal	Drawing No.
Checked :	Sandip	NUC(1) - TD - L3.5
Scale :	1:40	Serial No.
Date :	10/04/17	

**VASTU SHILPA CONSULTANTS**  
Architects | Planners | Urban Designers

"Sangath", Thaltej Road, Ahmedabad - 380054  
Phone: 079 - 27454537 Fax: 079 - 27452006  
www.sangath.org e-mail: vsc@sangath.org