

1 Master Plan: Storm Layout

SR.	MARK	DESCRIPTION	CAPACITY
1	DW-1	WASTE WATER TREATMENT PLANT	42KLD
2	DW-2	WASTE WATER TREATMENT PLANT	96KLD
3	DW-3	WASTE WATER TREATMENT PLANT	76KLD
3	DW-4	WASTE WATER TREATMENT PLANT	20KLD
4	ESR-1	OVER HEAD WATER STORAGE	60KL
5	ESR-2	OVER HEAD WATER STORAGE	60KL
6	ESR-3	OVER HEAD WATER STORAGE	60KL
7	ESR-4	OVER HEAD WATER STORAGE	60KL
8	ESR-5	OVER HEAD WATER STORAGE	60KL
9	T-1	CENTRAL TREATMENT STATION	450CUM
10	T-2	UG DRINKING WATER TREATMENT STATION (STUDENT HOUSING)	780CUM
11	T-3	UG DRINKING WATER TREATMENT STATION (ACADEMIC SPINE)	1400CUM
12	T-4	UG DRINKING WATER TREATMENT STATION (FACULTY HOUSING)	1400CUM
12	T-5	UG DRINKING WATER TREATMENT STATION (FACULTY HOUSING)	1400CUM
13	T-6	UG DRINKING WATER TREATMENT STATION (CAMPUS AMENITIES)	900CUM

No.	Date.	Remarks.
Revisions		

15.7.16	A1	VSC
Date	Prints	Issued to

Distribution of Prints

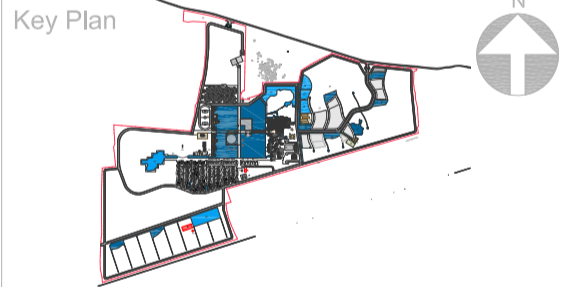

- Consultants
- ☐ **Structural Consultants**
VR SHAH Consulting Engineers
 - ☐ **Services Consultants**
dbHMS
2nd Floor, D-62, Sector -2,
Noida - 201301
www.dbhms.in
 - ☐ **Landscape Consultants**
Earthscapes Consultancy Pvt Ltd
 - ☐ **Road and Pathways Consultants**
Arhmm Infra Consultants LLP

Project

Nalanda University, Rajgir, Bihar

Title

MASTER PLAN - STORM LAYOUT
FOR TENDER

Dealt : JK	Drawing No.
Checked : AT	NUC-MP-P-P2.2
Scale : 1:2500	
Date : 15.07.2016	Approved: VM

VASTU SHILPA CONSULTANTS
Architects | Planners | Urban Designers

Sangath, Thaltej Road, Ahmedabad - 380054
Phone: 079 - 27454537 Fax: 079 - 27452006
www.sangath.org e-mail: vsc@sangath.org